

Brand: Hurricane  
Engine: HONDA/ACURA ACURA 1.8L LS/NON-VTEC,B18A/B  
Part Type: Connecting Rods  
Center to Center Length: 137mm/5.394"  
Big End Bore Diameter: 48mm /1.890"  
Big End Width: 23.75mm/0.935"  
Small End Bore Diameter: 21mm /0.827"  
Small End Width: 21mm/0.827"  
Beam Style: H-beam  
Connecting Rod Bolt Diameter: 3/8 "  
Approximate Connecting Rod Weight: 480g per piece  
Advertised Horsepower Rating: 750hp  
Quantity: Sold as 4pieces per set  
Material: Forged 4340 steel  
Connecting Rod Finish: Shot-peened, Polished  
Pin: Bronze wrist pin bushings  
Wrist Pin Style: Floating  
Cap Retention Style: Cap screw  
Weight Matched Set: Yes, Balanced +/- 1g  
Magnafluxed: Yes  
Private Label: Yes ,available  
Custom design: Yes, accept

## Honda B18A B18B B20 5.394 H beam Connecting Rod Description

Set of 4 Hurricane 4340 Chrome Moly Connecting Rods for HONDA/ACURA ACURA 1.8L LS/NON-VTEC,B18A/B are our best-seller rods, which are now available for Honda LS style engines. Features fully machined 4340 alloy steel, ARP 2000-3/8" bolts could be installed directly. Features include reinforcement pads around the bolt holes for added strength. Wide footprint mating surfaces at the parting line (where the rod comes apart for assembly) helps prevent big-end distortion under high RPM loads. Leave an message for more information, a great rod at a great price.

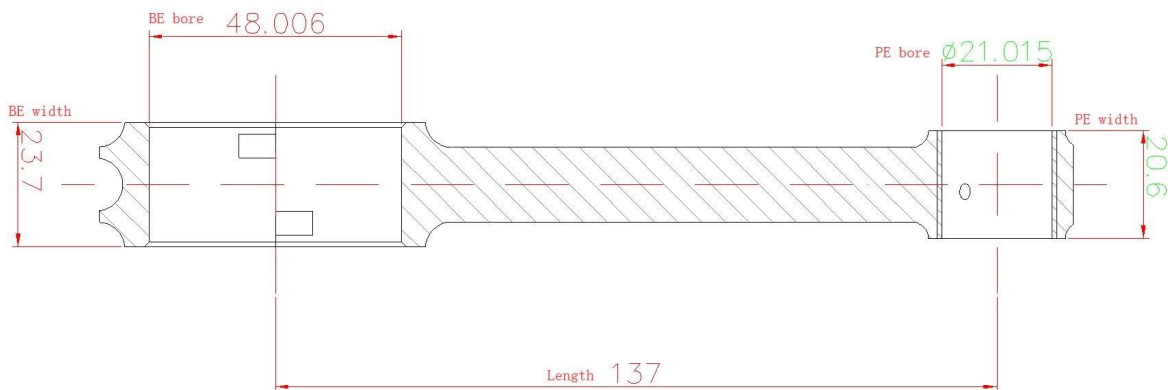

## H Beam Connecting Rods for Honda / Acura B18A B18B B20 Engines Features

### **1. Machined from One piece forgings**



### **2. Fully CNC Production Line**



### **3. Shot peened**



#### **4.Hurricane Speed and Performance Retail package**



**More Honda B series rods:**

1. [Honda Acura Integra GSR 1.8 VTEC B18C H-beam forged connecting rod , 5.433" rod length](#)
2. [Hurricane H-Beam Rods Honda B18](#)
3. [H-Beam Connecting Rods Honda Long rod 5.967 B18 B20 Connecting Rod](#)
4. [Hurricane Speed&Performance X Beam Rods Honda Integra LS CRV B18A B18B B20 5.394](#)
5. [H beam 4340 steel Connecting rods set for Honda B18, 20mm pin hole](#)
6. [H beam 4340 steel connecting rods for Honda B18C GSR,138mm rod length,21mm pin](#)

All ► [Acura & Honda Rods](#) here.