

Brand: Hurricane
Engine: Honda B18
Part Type: Connecting Rods
Center to Center Length: 140mm/5.511"
Big End Bore Diameter: 48mm/1.890"
Big End Width: 23.75mm/0.935"
Small End Bore Diameter: 20mm /0.787"
Small End Width: 22.86mm/0.900"
Beam Style: H-beam
Connecting Rod Bolt Diameter: 3/8 "
Approximate Connecting Rod Weight: ~g/piece
Advertised Horsepower Rating: 750hp
Quantity: Sold as 4pieces /set
Material: Forged 4340 steel
Connecting Rod Finish: Shot-peened, Polished
Pin: Bronze wrist pin bushings
Wrist Pin Style: Floating
Cap Retention Style: Cap screw
Weight Matched Set: Yes ,Balanced +/- 1g
Magnafluxed: Yes
Private Label: Yes ,available
Custom design: Yes, accept

Buy Civic Integra B18 H-Beam Connecting Rods 5.511" inch Rod Length: Connecting Rods - hurricanerods.com FREE DELIVERY possible on Hurricane Speed&Performance.

There some technical specification about our rods:

1. Forged 4340 steel, heat treatment: HRC34-38
2. One-piece forging



3. Pin bushing: QAL10-3-1.5



4. Steel bushing: 40Cr, HRC40-42

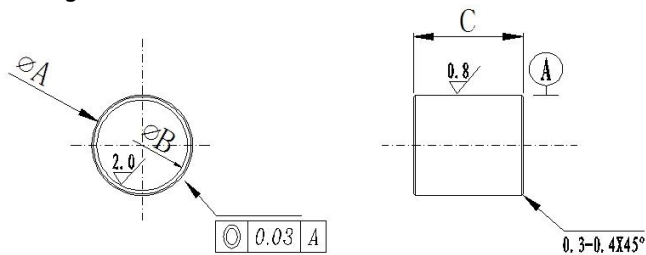

Tech Specs:
1. Material: 40Cr
2. HRC: 38-40



	mm		
Size	$\Phi A \pm 0.01$	$\Phi B \pm 0.08$	$C \pm 0.05$
7/16	12.70	11.45	13.8
3/8	11.12	9.85	13.45
5/16	9.52	8.15	12.95

Steel bush of connecting rod

5. bolt torque: 5/16-45N*M, 3/8-75N*M, 7/16-95N*M

6. Balance weight: $\pm 1g$

7. Tolerance: rod length: $\pm 0.05mm$, big end bore: $+0.013$, small end bore: $+0.005$, big end width: ± 0.02 and small end width: 0.05

Please kindly explore, any comments will be appreciated!

If you are interested with owning the Hurricane Speed&Performance Connecting Rods? [Fill out the form](#) for more information! Or Leave an message to marketing@hurricane-rod.com.cn

If you are interested with std Honda B series rods, you could explore directly, included:

1. [Honda B16 H beam 4340 steel connecting rods,136mm length,20mm pin](#)
2. [Hurricane H-Beam Rod Honda Civic Si B16 B16A B16A2](#)
3. [Set of 4 Hurricane 4340 Chrome Moly Connecting Rods for HONDA/ACURA ACURA 1.8L LS/NON-VTEC,B18A/B](#)
4. [Honda Acura Integra GSR 1.8 VTEC B18C H-beam forged connecting rod , 5.433" rod length](#)