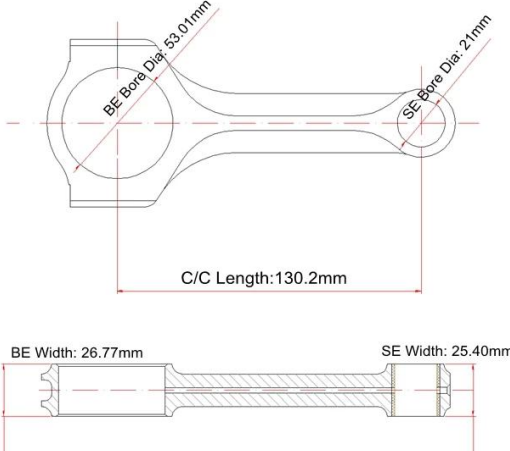

Nissan Datsun L16/L18 X-beam Conrods Main Sizes

| | |
|---|--|
| Brand: Hurricane* |  |
| Center to Center Length: 130.2mm/5.126" | |
| Big End Bore Diameter: 53.01mm/2.087" | |
| Big End Width: 26.77mm/1.054" | |
| Small End Bore Diameter: 21mm /0.827" | |
| Small End Width: 25.4mm/1.000" | |
| Beam Style: X-beam | |

Nissan Datsun L16/L18 X-beam Conrods Features

| | |
|-----------------------------------|-----------------------------------|
| Connecting Rod Bolt Diameter | 3/8 " |
| Approximate Connecting Rod Weight | xxx |
| Advertised Horsepower Rating | 600hp |
| Quantity | Sold as 4 pieces /set |
| Material | Forged 4340 steel |
| Connecting Rod Finish | Shot-peened, Polished |
| Pin | Bronze wrist pin bushings |
| Wrist Pin Style | Floating |
| Cap Retention Style | Cap screw |
| Weight Matched Set | Yes ,Balanced +/- 1g |
| Magnafluxed | Yes |
| Private Label | Yes ,available |
| Custom design | Yes, accept |

Additional Description :

- 1.Manufactured from high strength 4340 Chrome Moly Steel .
- 2.Designed and optimized by 3d software .

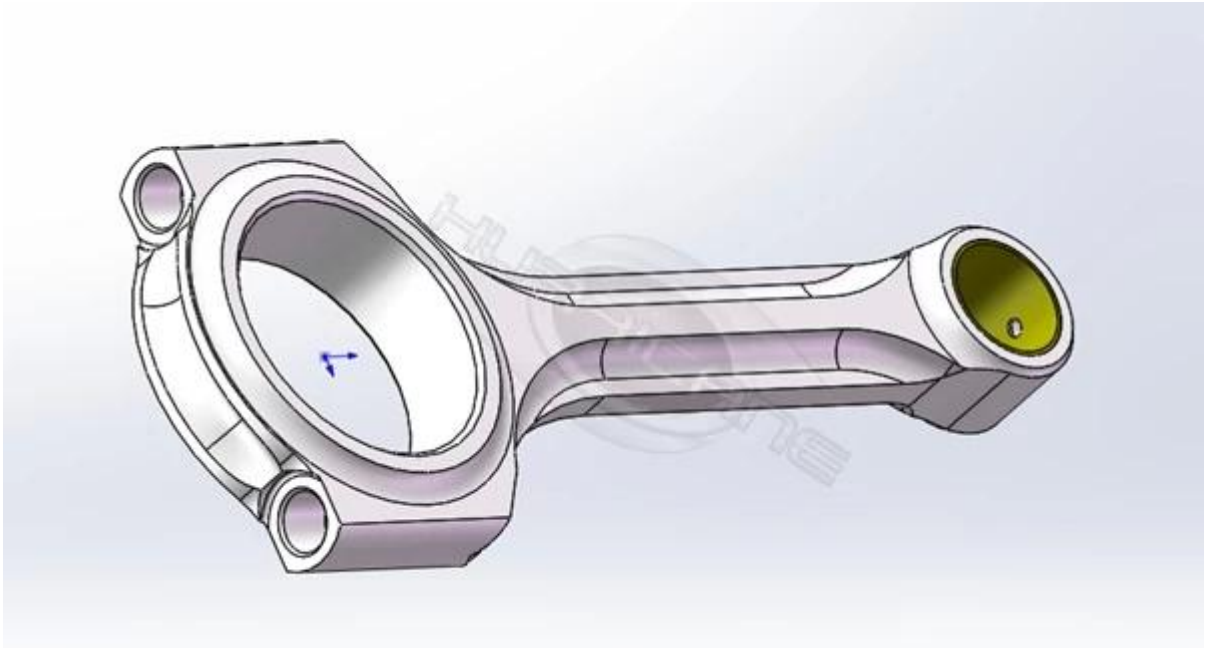

3. Fully processed by CNC machine.





4.Popular X-beam style combines weight saving and strength.

5.100% X-rayed, sonic tested and magnafluxed for increased strength.

6.All big and small ends are finished with SUNNEN honing machine to meet high quality standard .

7. Small ends came with high quality bronzed bushing suitable for the floating piston pin.



If you are interested in this rod ,please contact us online or send email to marketing@hurricane-rod.com.cn . our team will guide you how to place the order .