

Nissan Datsun L16/L18 X-beam Conrods Main Sizes

Brand: Hurricane*	
Center to Center Length: 130.2mm/5.126"	
Big End Bore Diameter: 53.01mm/2.087"	
Big End Width: 26.77mm/1.054"	
Small End Bore Diameter: 21mm /0.827"	
Small End Width: 25.4mm/1.000"	
Beam Style: X-beam	

Nissan Datsun L16/L18 X-beam Conrods Features

Connecting Rod Bolt Diameter	3/8 "
Approximate Connecting Rod Weight	xxx
Advertised Horsepower Rating	600hp
Quantity	Sold as 4 pieces /set
Material	Forged 4340 steel
Connecting Rod Finish	Shot-peened, Polished
Pin	Bronze wrist pin bushings
Wrist Pin Style	Floating
Cap Retention Style	Cap screw
Weight Matched Set	Yes ,Balanced +/- 1g
Magnafluxed	Yes
Private Label	Yes ,available
Custom design	Yes, accept

Additional Description :

- 1.Manufactured from high strength 4340 Chrome Moly Steel .
- 2.Designed and optimized by 3d software .

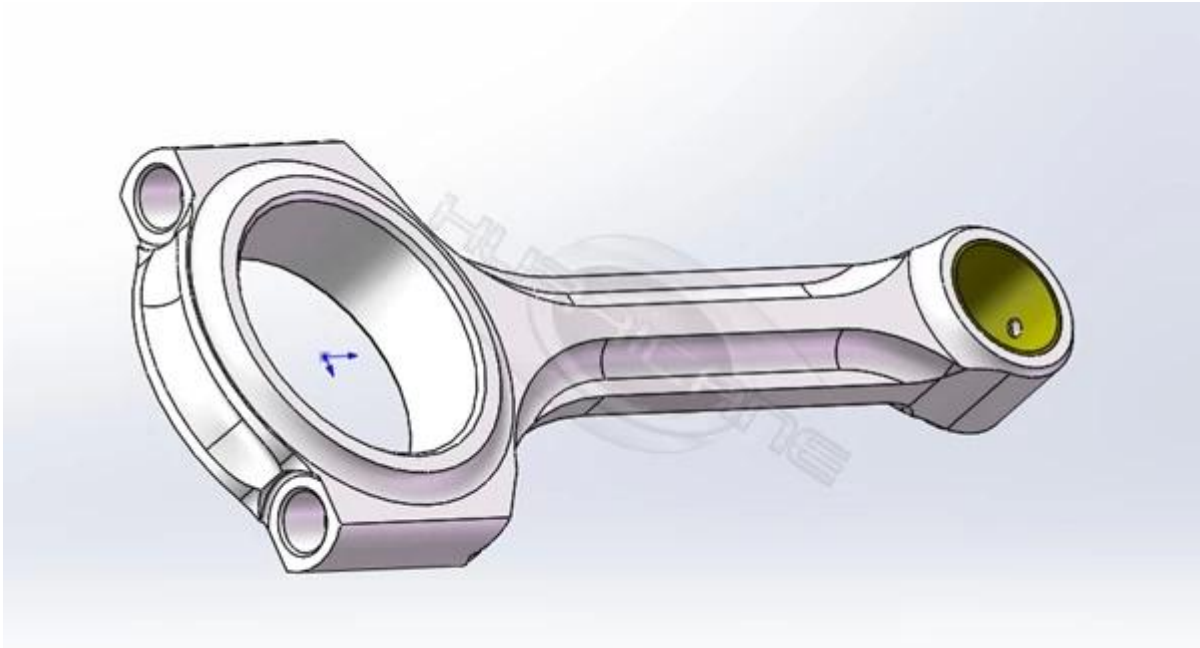

3. Fully processed by CNC machine.





4. Popular X-beam style combines weight saving and strength.

5. 100% X-rayed, sonic tested and magnafluxed for increased strength.

6. All big and small ends are finished with SUNNEN honing machine to meet high quality standard .

7. Small ends come with high quality bronzed bushing suitable for the floating piston pin.



If you are interested in this rod ,please contact us online or send email to marketing@hurricane-rod.com.cn . our team will guide you how to place the order .