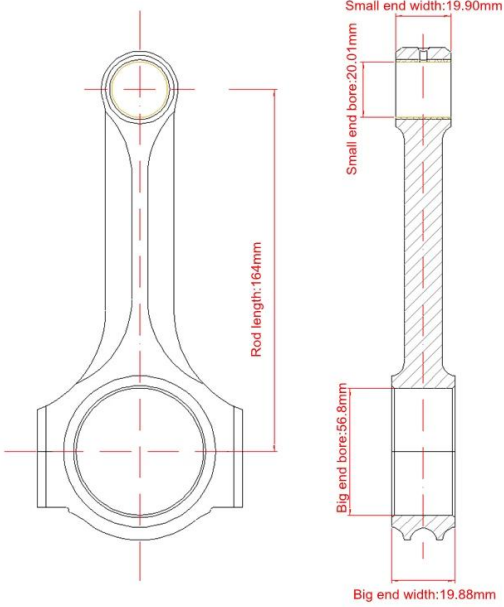

5-Cylinder 2.3 20V V5 VR5 X-beam connecting rod Main Sizes

Brand: Hurricane	 <p>Small end width: 19.90mm Small end bore: 20.01mm Rod length: 164mm Big end bore: 56.8mm Big end width: 19.88mm</p>
Center to Center Length: 164mm/6.457"	
Big End Bore Diameter: 56.80mm/2.236"	
Big End Width: 19.88mm/0.783"	
Small End Bore Diameter: 20.01mm /0.788"	
Small End Width: 19.90mm/0.783"	
Beam Style: X-beam	

Volkswagen connecting rod (VAG) AQN/AZX 2.3 Ltr 20V V5 Features

Connecting Rod Bolt Diameter	5/16 "
Approximate Connecting Rod Weight	xxxg
Advertised Horsepower Rating	1000hp
Quantity	Sold as 5 pieces /set
Material	Forged 4340 steel
Connecting Rod Finish	Shot-peened, Polished
Pin	Bronze wrist pin bushings
Wrist Pin Style	Floating
Cap Retention Style	Cap screw
Weight Matched Set	Yes ,Balanced +/- 1g
Magnafluxed	Yes
Private Label	Yes ,available
Custom design	Yes, accept

VW Bora 2.3 Ltr V5 20V 5 Cyl X-beam rods Description

X-Beam design

this feature allows more strength than H-beam.

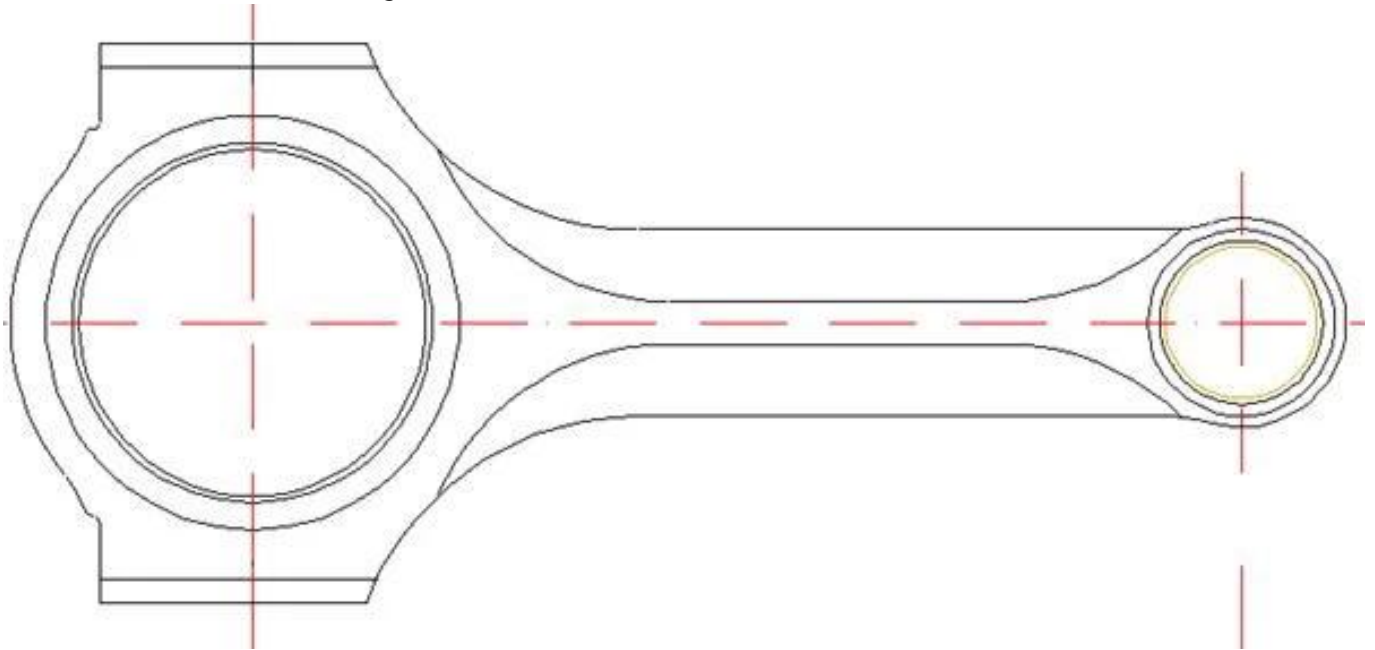

Professional design engineers

All rods are designed specifically for the application with professional engineers, who design rods over 20 years.

Rifle drilled

Also referred to as Forced Pin Oiling (FPO), rifle drilling increases wrist pin longevity by providing additional lubrication. This upgrade is highly recommended for street-driven cars that see mileage put on them. Rifle drilling is an additional process and sold separately on this application.



Honed bore

Honing the connecting rod big end bore and small end bore, which you could use directly when you get them.

Material forged 4340 steel

Made from strong and one-piece 4340 forgings ,these rods will withstand almost everything you can throw at them.

ARP2000 bolt

All rods deisgned and made for standard with ARP 2000 rod bolts. Ensure that you could get bolt easliy

Arp2000 bolt torque specs

Generally, 45N*M. Of course, we will assemble and honing bore with your special torque if necessary