

Brand: Hurricane
Engine: Nissan TB48
Part Type: Connecting Rods
Center to Center Length: 163.47mm/6.436"
Big End Bore Diameter: 59.99mm/2.362"
Big End Width: 32.76mm/1.290"
Small End Bore Diameter: 23.01mm /0.906"
Small End Width: 26.04mm/1.025"
Beam Style: I-beam
Connecting Rod Bolt Diameter: 7/16
Approximate Connecting Rod Weight: 760g/piece
Advertised Horsepower Rating: 1200hp
Quantity: Sold as 6pieces /set
Material: Forged 4340 steel
Connecting Rod Finish: Shot-peened, Polished
Pin: Bronze wrist pin bushings
Wrist Pin Style: Floating
Cap Retention Style: Cap screw
Weight Matched Set: Yes ,Balanced +/- 1g
Magnafluxed: Yes
Private Label: Yes ,available
Custom design: Yes, accept

TB48 I-BEAM CONNECTING RODS

Hurricane offers an I-Beam style connecting rod for the ultimate horsepower requirements. Rated in excess of 1200+ HP, the Hurricane I beam connecting rods are for the serious enthusiast. Features ARP2000 7/16" bolts for ultimate clamping ability. Feature as follows:

1. **Custom shoulder design**, advantages:

- 1). Give you an edge over your competitors;
- 2). Increase touch area between rods and caps, improve Repeatability of big end bore;
- 3). Increase strength when bolt connect rods with caps.

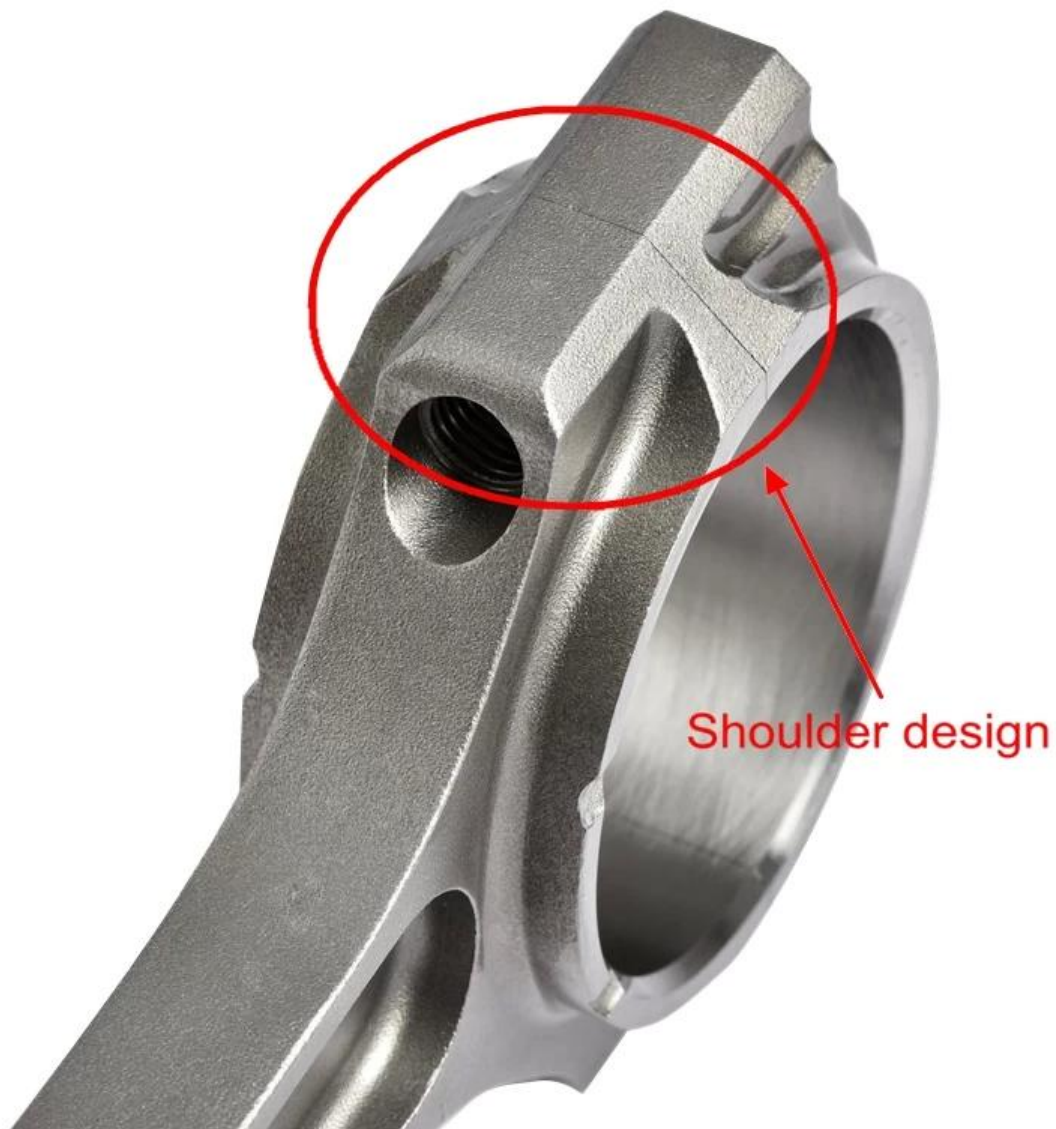

2. **Groove in Thrust Face**, Advantages:

All rods come with grooves in thrust face, feature that allows weight reduction and reduced friction.

3. **I-beam**, Advantages:

Just like in H-Beam tapered pin end, this feature allows weight saving and increased clearance when using boxed pistons.

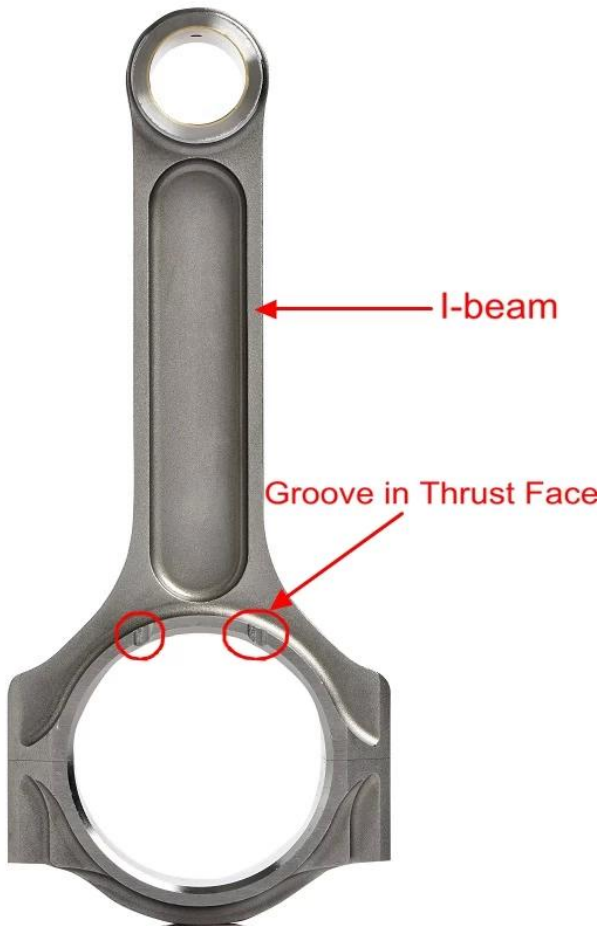

Note: More Hurricane connecting rods here, please kindly explore if you are interested:

1. [Hurricane Connecting Rods Features 1](#)
2. [Hurricane Connecting Rods Features 2](#)
3. [Hurricane Connecting Rods Pin End Design](#)
4. [Hurricane Connecting Rods Big End Design](#)
5. [Hurricane Connecting Rod Features - Various Beam Designs](#)
6. [Hurricane Connecting Rod Shoulder Design](#)

Featured products, [Nissan TB48 H beam forged 4340 steel connecting rods](#). Click here for more information. A great rod at a great price.

Nissan Car

