

Brand: Hurricane
Engine: BMW M5/M6 S-88
Part Type: Connecting Rods
Center to Center Length: 144mm/5.669"
Big End Bore Diameter: 52mm/2.047"
Big End Width: 23.9mm/0.941"
Small End Bore Diameter: 22mm /0.866"
Small End Width: 23.9mm/0.941"
Beam Style: H-beam
Connecting Rod Bolt Diameter: 3/8"
Approximate Connecting Rod Weight: 500g/piece
Advertised Horsepower Rating: 900hp
Quantity: Sold as 6 pieces /set
Material: Forged 4340 steel
Connecting Rod Finish: Shot-peened, Polished
Pin: Bronze wrist pin bushings
Wrist Pin Style: Floating
Cap Retention Style: Cap screw
Weight Matched Set: Yes ,Balanced +/- 1g
Magnafluxed: Yes
Private Label: Yes ,available
Custom design: Yes, accept

Hurricane finished BMW M5/M6 S-88 Steel connecting rod Features:

1. 100% CNC machined



2. Standard H beam design greatly increases strength and durability

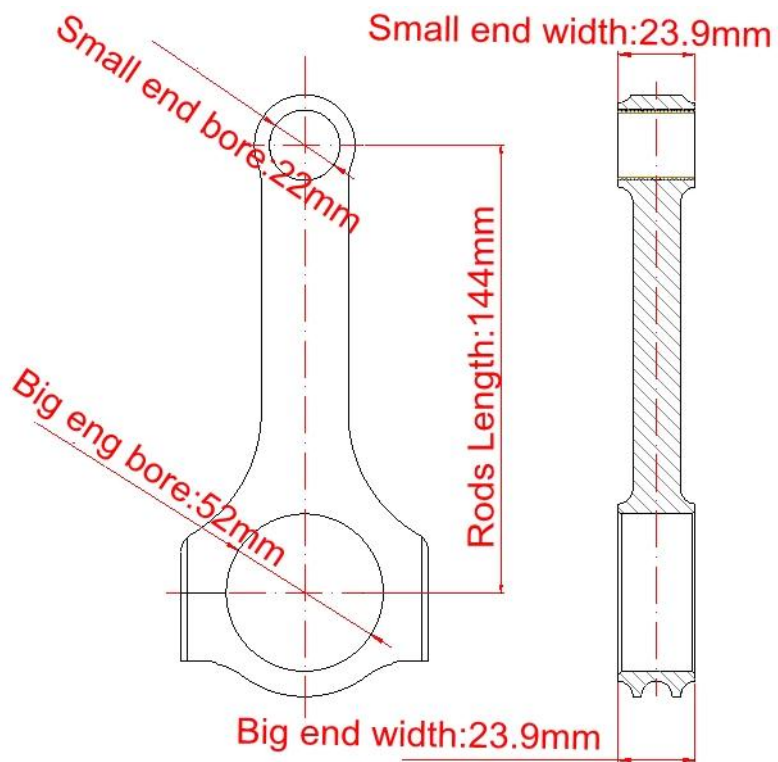

3. Bronze wrist pin bushings are fitted to each rod to increased wear resistance



4. Weight matched to +/- 1 grams per set. After you got them, you could install directly.

All BMW connecting rods here, act

now! If you have any questions, please feel free to tell us on Live Chat or leave an message to Marketing@hurricane-rod.com.cn .